

D. D. A.

RIVER YAMUNA PROJECT

TOTAL AREA OF THE SCHEME	= 3.740 HA.
AREA UNDER PARK	= 1.4035
AREA UNDER CIRCULATION	= 0.6365
AREA UNDER O.C.F.	= 0.4000
AREA UNDER SR. SEC. SCHOOL	= 0.8000
AREA UNDER GRAVE YARD	= 0.4000
AREA UNDER DISPENSARY	= 0.1000
<b>TOTAL</b>	<b>= 3.7400 HA.</b>

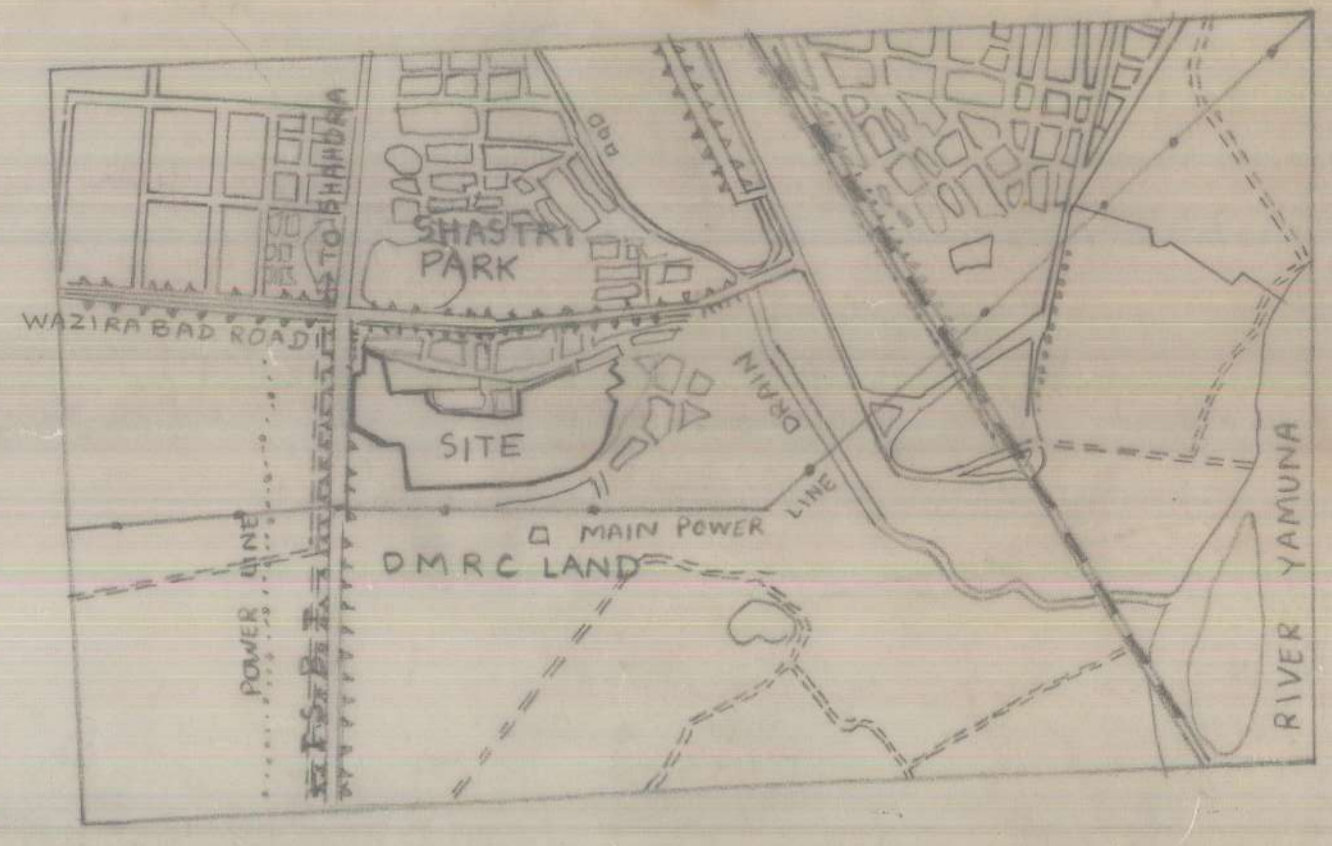

KEY PLAN  
SCALE = 1:10,000

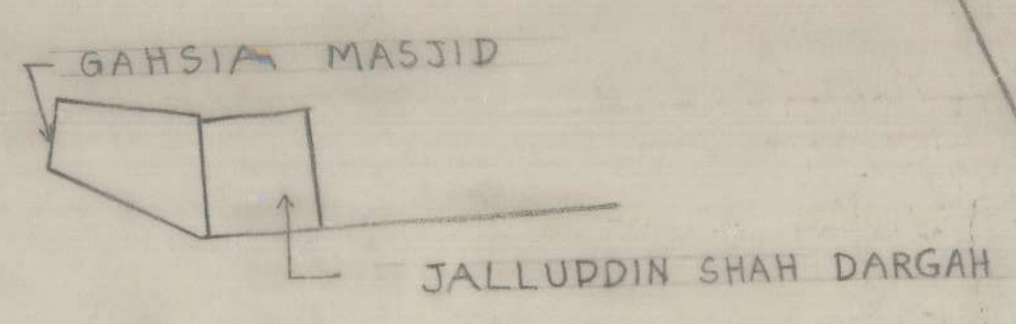
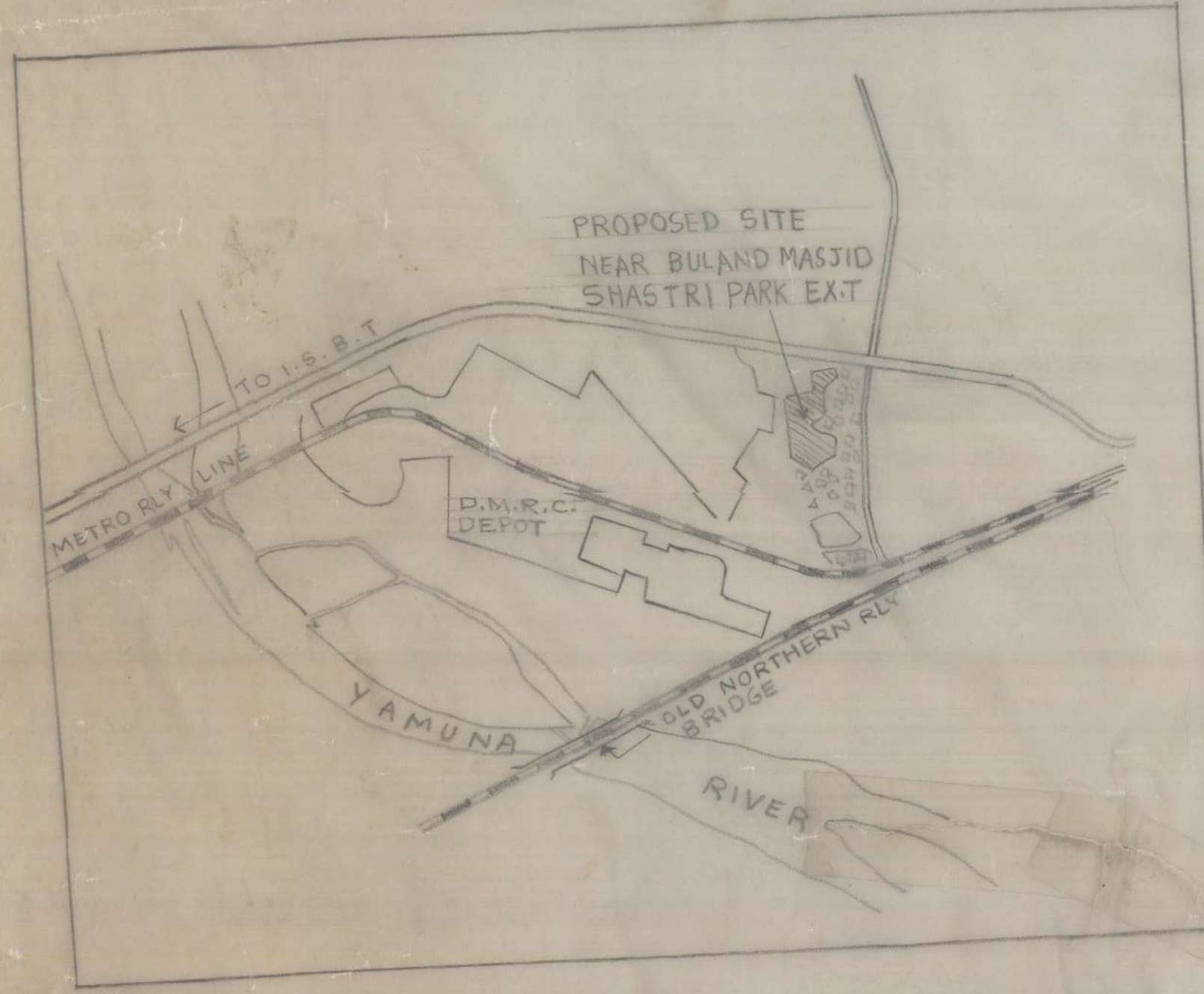
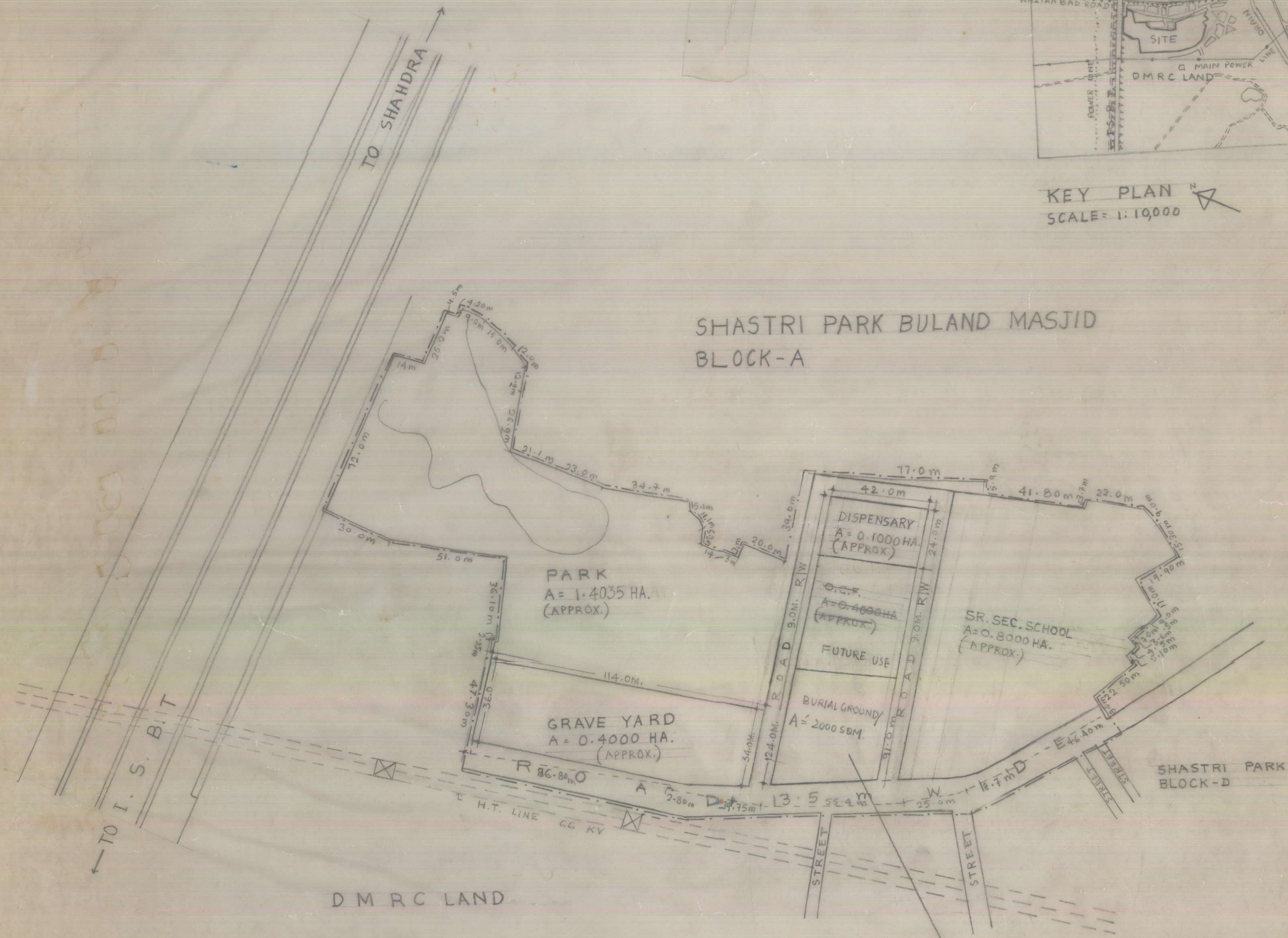

396<sup>th</sup> SCREENING COMMITTEE MEETING HELD ON 17-07-2021, VIDE ITEM NO. 50:2021 APPROVED THE PART MODIFICATION IN THE LAYOUT PLAN TITLED: "MODIFIED PLAN OF DDA VACANT LAND NEAR BULAND MASJID, SHASTRI PARK EXTN." W.R.T. ALLOTMENT OF ADDITIONAL LAND FOR EXISTING GRAVEYARD/BURIAL GROUND NEAR BULAND MASJID, SHASTRI PARK IN PLANNING ZONE 'D', AS UNDER:  
 (1) A SITE MEASURING 2000 SQ.M. BE FARMARKED FOR THE BURIAL GROUND ALONG THE ROAD.  
 (2) BALANCE AREA BE RESERVED FOR FUTURE USE.  
 THE DETAILED DRAWING IS PLACED AT PAGE- 795/C IN FILE NO. F-3 (10)/99-MP AND PAGE- 122/C IN E-FILE NO. PLG/MP/0003/2021/F-20/06 DT. DIRECTOR (PLG) MPBDC.

Sd/- DIRECTOR (PLG) ZONE E20      Sd/- ASST. DIR. (PLG) ZONE 'D'      Sd/- PLG. ASST. ZONE D

**NOTE**  
 \* THIS PLAN IS BASED ON THE P.T. SURVEY OF D.D.A. LMD AT SHASTRI PARK NEAR BULAND MASJID DRG. NO. SIE/285/99 DT. 12-12-97. PLACED AT 198 C IN FILE F-3(10)/99 MP.  
 \* THIS WAS DISCUSSED IN TECHNICAL COMMITTEE MEETING HELD ON 22.7.2005 VIDE ITEM NO. 26/2005. TECHNICAL COMMITTEE RECOMMENDED THE APPROVAL OF PROCESSING THE CASE OF CHANGE OF LAND USE SUBJECT TO APPROVAL OF YAMUNA COMMITTEE (C.W.C.) AND N.O.C. FROM U.C.D.  
 \* THE PROPOSAL WAS DISCUSSED IN THE 70<sup>th</sup> MEETING OF YAMUNA STANDING COMMITTEE, C.W.C. ON 22.11.2005 THE FOLLOWING DECISION WAS GIVEN, IN VIEW OF THE FACT THAT WITH DEVELOPMENT OF ADDITIONAL LAND ON WESTERN SIDE BY THE DMRC FOR DEPOT AND I.T. PARK, PLOT OF LAND FOR THE PROPOSED CHANGE OF LAND USE WOULD NOT GET INUNDATED DUE TO RIVER YAMUNA IT WAS AGREED TO CLEAR THE PROPOSAL.  
 \* THE PROPOSAL OF CHANGE OF LAND USE 1.70 HA. FROM "AGRICULTURE AND WATER BODY" TO PUBLIC AND SEMI PUBLIC USE WAS APPROVED BY AUTHORITY VIDE RESOLUTION NO. 5/2006 DATED 19.01.2006.  
 \* PUBLIC NOTICE INVITING OBJECTION/SUGGESTIONS WAS ISSUED VIDE NOTIFICATION NO. 215(E) DT. 26 DEC. 2006 IN RESPONSE TO THE PUBLIC NOTICE FOR OBJECTION/SUGGESTIONS WERE CONSIDERED BY SPECIAL SCREENING BOARD IN ITS MEETING HELD ON 4<sup>th</sup> APRIL 2007.  
 \* PROPOSED CHANGE OF LAND USE OF 1.70 HA. OF LAND IN BULAND MASJID AREA (SHASTRI PARK EXTN.) IN RIVER YAMUNA BED ZONE 'D' APPROVED IN THE AUTHORITY MEETING HELD ON 22.6.07 VIDE ITEM NO. 63/2007 FILE NO. F-3(10)/99 MP ON PAGE NO. 485/C.  
 \* CHANGE OF LAND USE WAS NOTIFIED VIDE GAZETTE OF INDIA NOTIFICATION NO. 5,0 1748 (E) DATED 12.10.2007.  
 \* THE MODIFIED LAY OUT PLAN WAS DISCUSSED IN THE 262<sup>nd</sup> MEETING OF SCREENING COMMITTEE MEETING HELD ON 18.11.2005. THE FOLLOWING DECISION WAS GIVEN IT WAS DECIDED THAT THE STATUS OF EMBANKMENT BE CHECKED AND THEN A SUITABLE AGENDA BE PREPARED AND PUT UP BEFORE THE SCREENING COMMITTEE AGAIN (ITEM NO. 0422008).  
 \* THE SCHEME WAS DISCUSSED IN THE 263<sup>rd</sup> SCREENING MEETING HELD ON 18.3.08 VIDE ITEM NO. 10/05/BM/LP-1 THE PROPOSAL AS REFLECTED IN THE AGENDA HAS BEEN APPROVED WITH THE OBSERVATION THAT THE WORDS "RIVER YAMUNA BED" BE DELETED FROM THE SUBJECT OF AGENDA AND BE TERMED AS "ZONE-0".  
 \* THIS DRAWING SUPERSEDES THE EARLIER DRAWING NO. 10/05/BM/LP-1  
 \* ALL DIMENSIONS ARE SUBJECT TO VERIFICATION AT SITE

MODIFIED PLAN FOR DDA VACANT LAND NEAR BULAND MASJID, SHASTRI PARK EXTN.

DATE = 19.10.04	DRG. NO.	PLG. D/MAN
SCALE = 1:1000		
DD. Asst. PLG. ASST.	ASST. DIR.	JT. DIRECTOR
D. D. A.	O.S.U. (PLG)	

DRG. NO. - 11/07/BM/LP-1.M.